

Rzut montażowy elementów parteru

Assembly plan elements of ground floor

1:50

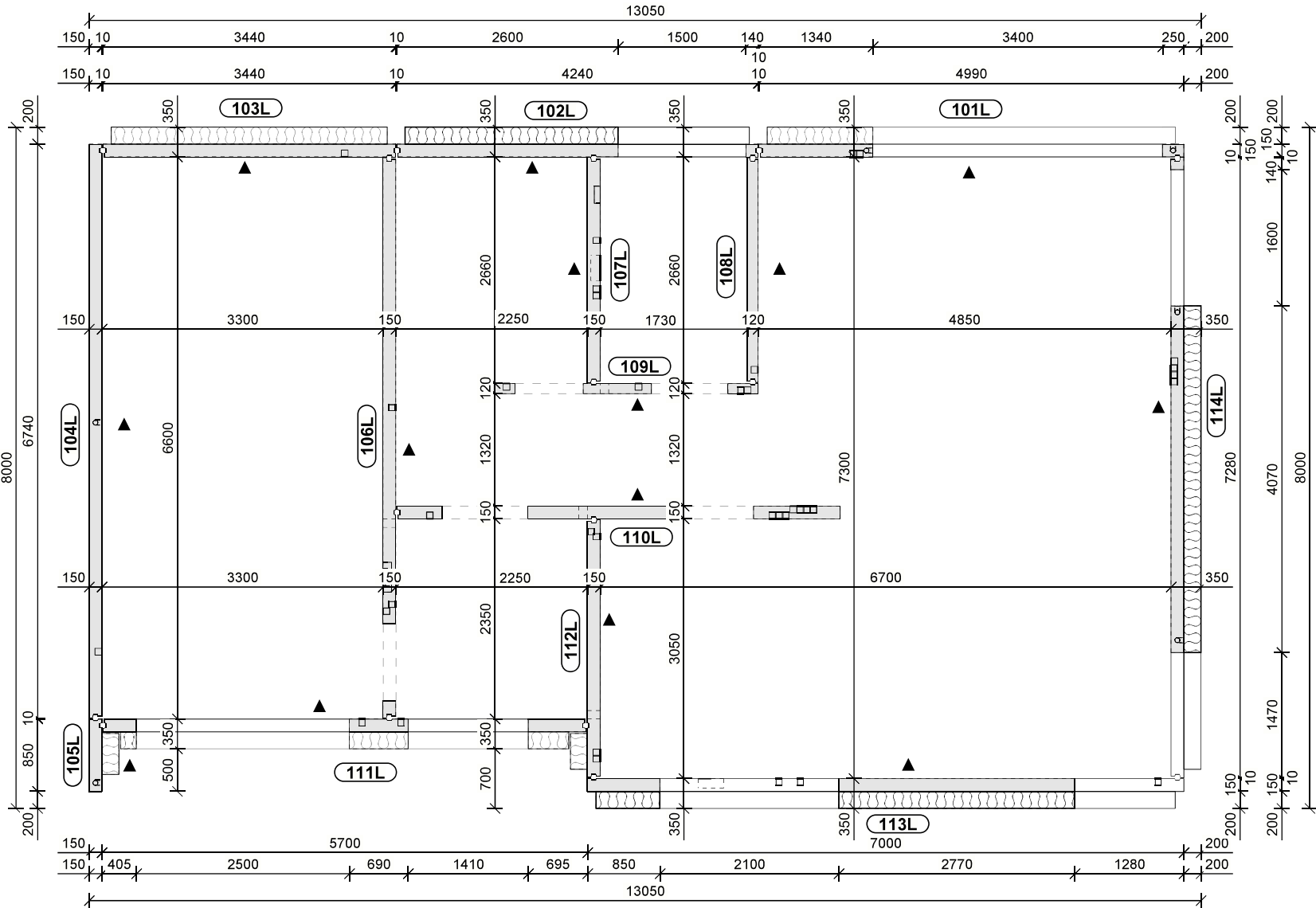

Zestawienie elementów ściennych

List of wall elements

| Nr/No | dt./L (mm) | Wys./H (mm) | Gr./T (mm) | Pow./A (m ²) | Wag./W (T) | Wys. dołu el. Bottom level |
|--------------|-------------|-------------|------------|-----------------------------|--------------|----------------------------|
| 101L | 4990 | 3220 | 350 | 16.07 | 2.8 | -0.180 |
| 102L | 4240 | 3220 | 350 | 13.65 | 4.6 | -0.180 |
| 103L | 3440 | 3220 | 350 | 11.08 | 3.9 | -0.180 |
| 104L | 6740 | 3220 | 150 | 21.70 | 7.6 | -0.180 |
| 105L | 850 | 3220 | 350 | 2.74 | 1.0 | -0.180 |
| 106L | 6580 | 3220 | 150 | 21.19 | 6.6 | -0.180 |
| 107L | 2840 | 3220 | 150 | 8.50 | 2.9 | -0.180 |
| 108L | 2840 | 3020 | 120 | 7.97 | 2.3 | -0.180 |
| 109L | 3185 | 3020 | 120 | 9.62 | 1.7 | -0.180 |
| 110L | 5205 | 3040 | 150 | 15.82 | 4.1 | -0.180 |
| 111L | 5680 | 3040 | 350 | 17.27 | 3.1 | -0.180 |
| 112L | 3030 | 3040 | 350 | 9.21 | 3.3 | -0.180 |
| 113L | 7000 | 3220 | 350 | 22.54 | 6.2 | -0.180 |
| 114L | 7440 | 3220 | 350 | 23.96 | 6.2 | -0.180 |
| Razem/ Total | 14 elements | | | Pow.= 201.32 m ² | Wag.= 56.1 T | |

(M10LSL) -LISTA STALI

Widok 3d elementów

3D view of elements

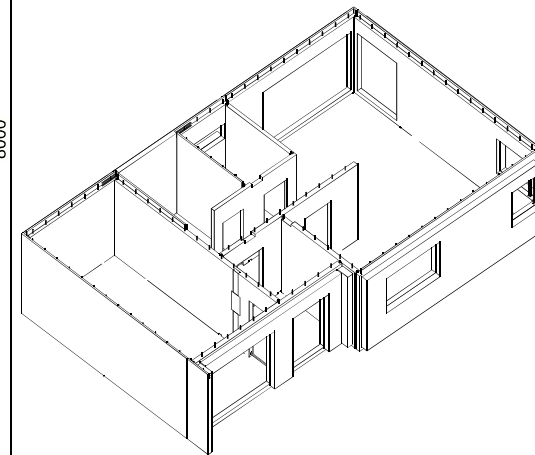

Detal posadowienia ścian

1:30

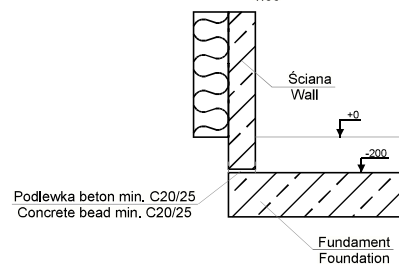

SYMBOLE POWIERZCHNI

▲ POW. OD SPODU FORMY